

# SHEVS Control Centre RWZ 7

System diagram (version with indication of position)  
(please consider local conditions / components)

Components in additional SHE / ventilation groups will be connected as shown for the first group.

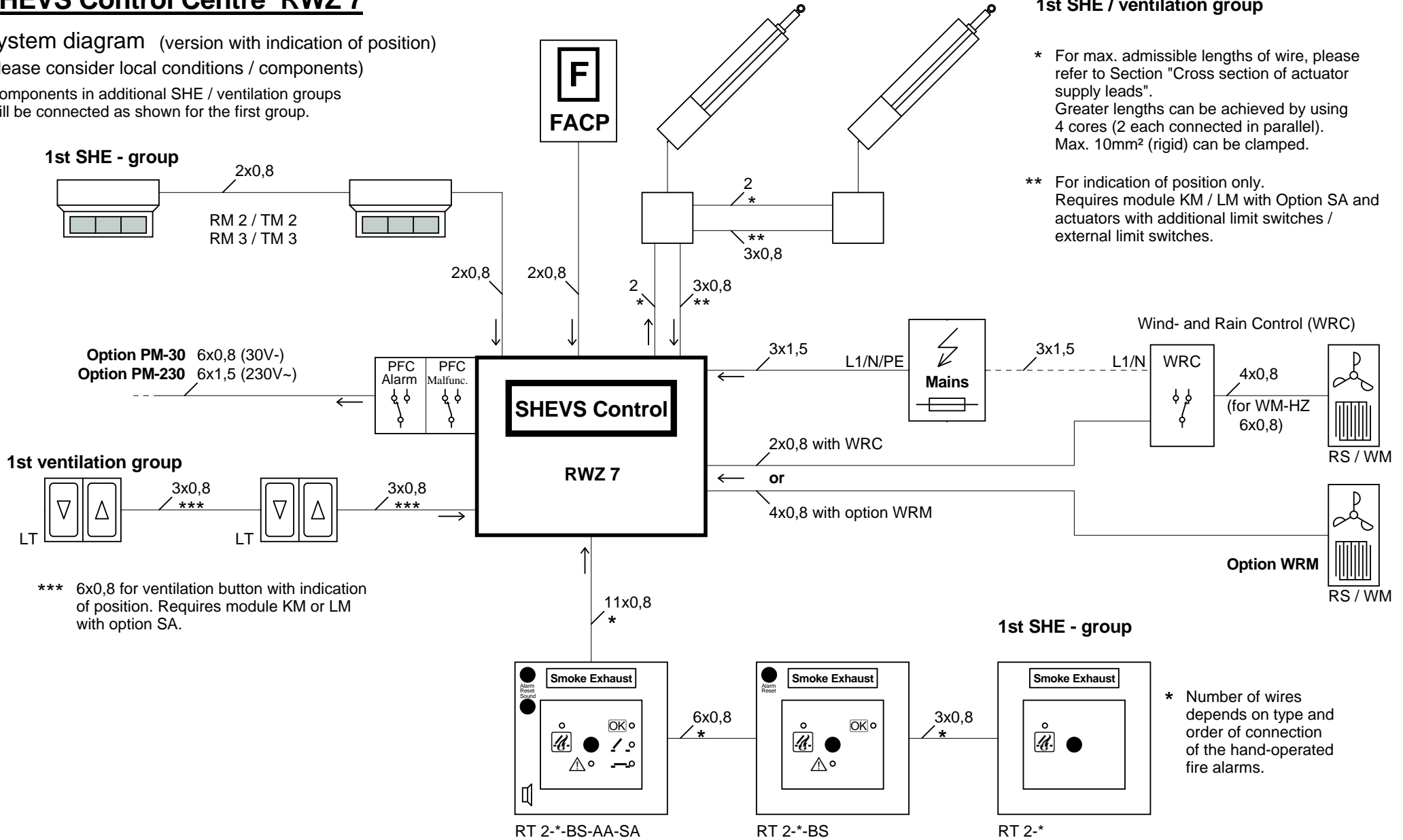

## 1st SHE / ventilation group

\* For max. admissible lengths of wire, please refer to Section "Cross section of actuator supply leads". Greater lengths can be achieved by using 4 cores (2 each connected in parallel). Max. 10mm<sup>2</sup> (rigid) can be clamped.

\*\* For indication of position only. Requires module KM / LM with Option SA and actuators with additional limit switches / external limit switches.

\*\*\* 6x0,8 for ventilation button with indication of position. Requires module KM or LM with option SA.

## 1st SHE - group

\* Number of wires depends on type and order of connection of the hand-operated fire alarms.

General: maximum length of line 400m, unless specified otherwise